

Wohlbold Cemetery

By Dave Hallemann



This very overgrown cemetery is located in T41 R4 S4 SE $\frac{1}{4}$ of the NE $\frac{1}{4}$.

38° 19' 15" N / 90° 34' 26" W

This cemetery was visited 24th April 2005 by Dave Hallemann.

This tract was first registered by Lewis Riddle on 8th August 1840, Certificate #13043, for the East half of lot 1 of the SE $\frac{1}{4}$ of the NE $\frac{1}{4}$ T41

R4 S4, containing 40 acres.

Probate Record #431 for Lewis Riddle shows he had no heirs except his widow, Fredericka who was also his Administrator. His will reads that Fredericka was to receive everything, that at the time of his death he owned a 104 acre tract of land, an 80 tract, and a 40 acre tract. His will was dated 17 April 1849. Isaac Herington sued and received \$411+ cost and interest on a note he held. Fredericka was ordered by the Jefferson County Court on 17th June 1854 to sell as much land as necessary to pay the debt. Many of the records show Louis however in his will he signs Lewis.

The 1850 Census show Louis Riddle as 47, Fredericka also 47, and living with them Charles Miller and his wife Louisa and their children. By 1860 Lewis has passed and Fredericka is living with her son John H. Fox and family. Fredericka passes before the next deed.

12th October 1860 we find John H. Fox and Mary his wife also Charles Miller and Louisa his wife formerly Louisa Fox of Jefferson County selling to Julia A Letcher wife of Isaac A. Letcher of St. Louis for \$1500.⁰⁰, "...E $\frac{1}{2}$ of Lot 2 of the NE $\frac{1}{4}$ T41 R4 S4 containing 63.⁰⁸ acres, and the E $\frac{1}{2}$ of Lot 1 of the NE $\frac{1}{4}$ T41 R4 S4 containing 40 acres, also the W $\frac{1}{2}$ of the SW $\frac{1}{4}$ of the SW $\frac{1}{4}$ T41 R4 S3 containing 20 acres...conveyed in the last will of Lewis Riddle to Fredricka Riddle and inherited by John H. Fox and Louisa Miller being the only children of Fredricka Riddle subject to two deeds of trust in favor of Josiah Craft..." as recorded in Book Q Page 633.

Recorded in Book 14 Page 609, dated 10th July 1866 Mrs. Julia A. Letcher wife of Isaac A. Letcher, deceased, sells the tract to Laura Caroline Letcher wife of Jacob A. Letcher, for \$1.⁰⁰, her "Dixie Farm", "...E $\frac{1}{2}$ of Lot 2 of the NE $\frac{1}{4}$ T41 R4 S4 containing 63.⁰⁸ acres, and the E $\frac{1}{2}$ of Lot 1 of the NE $\frac{1}{4}$ T41 R4 S4 containing 40 acres, also the W $\frac{1}{2}$ of the SW $\frac{1}{4}$ of the SW $\frac{1}{4}$ T41 R4 S3 containing 20 acres...being the same premises devised by will of Louis Riddle to his wife Fredricka through whom by inheritance John H. Fox and Louisa Miller his sister came into possession and who sold to Mrs. Julia A Letcher as recorded in Book Q Page 633.

In the 1870 Census we find J. Letcher a male 43, farmer, Laura 24, Julia 5, and Sallie 2. The property valuation is \$3000 so this was a very profitable farm.

On 2nd June 1879, Laura C. Letcher, widow, of St. Louis sells to Joseph Bechler of Jefferson County, for \$900.⁰⁰, "...E½ of Lot 2 of the NE¼ T41 R 4 S4 containing 63.⁰⁸ acres, and the E½ of Lot 1 of the NE¼ T41 R 4 S4 containing 40 acres, also the W½ of the SW¼ of the SW¼ T41 R4 S3 containing 20 acres..." deed being recorded in Book 14 Page 611.

Recorded in Book 15 Page 484, Joseph Bechler sells the tract to Barbara Wohlbold on 22nd January 1880, for \$1100.⁰⁰. "...except 3 acres out of the northeast corner which contains 2 springs..."

In Book 42 Page 297 we find that on the 28th February 1895 Joseph Bechler and his wife Ernestina sell to Charles Wohlbold, "...All of a 3 acre tract out of the northeast corner T41 R4 S4... Recorded in deed Book 15 Page 484.

Joseph Bechler died in 1897 and is buried on a farm about 1 miles south of this tract. (*see my article on Bechler Cemetery*)

Karl and Wilhelm Wohlbold were probably twins as their birthday is the same, August 9th, 1878. We know little of the passing of Karl but the Jefferson Democrat of Hillsboro, Jefferson, Missouri, dated Wednesday, 27 July 1887, had the following article;

A sad accident occurred at Charles WOHLBOLD's near Belew's Creek post office, last week. His eight-year old son was kicked by a young horse, took lock-jaw and died after lingering in intense pain for two days. Our sympathies are extended to the grief-stricken parents.

And Jefferson County Permanent Record of Death list;

Willie Wohlbold, white male aged 9 years; place of death *Central Twp*; cause of death *Fracture of Cranium; Complications, Traumatic tetanus*; duration of disease, *2 days*; Doctor signing certificate, *F E Guibon MD, House Springs, MO*.

The 1900 Census show that Charles, Barbara, sons Henry, Robert, and daughter Emma still living in central township however on 12th December 1918, Charles and Barbara Wohlbold of *St. Louis*, sell to Arnold Loewenstein, single, of St. Louis, for \$1.⁰⁰ the above property, as recorded in Quit Claim Book 5 Page 89.

Finally in probate Record 4299, dated June 1919, Barbara Wohlbold refuses the administration of Charles estate. Whether Charles and Barbara are buried here is uncertain as they were living in St. Louis at their time of death but there appears to *possibly* be more unmarked graves in this cemetery.

Although no deed was found "excepting out" this cemetery, with the above evidence, I feel we can "unofficially" call this one **Wohlbold Cemetery**

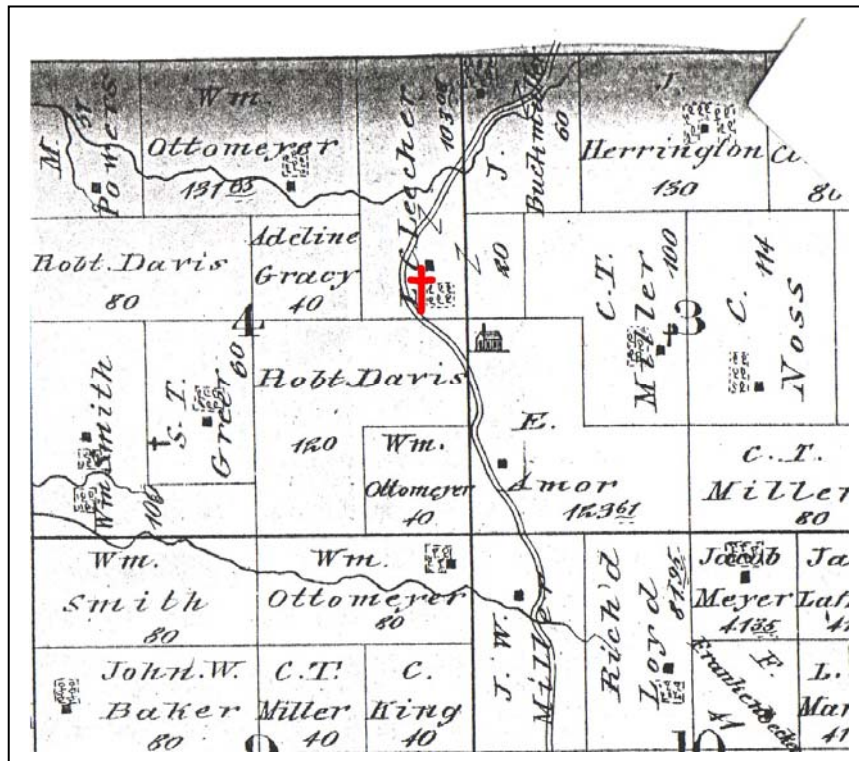

The 1876 Historic Atlas show L. C. Lecher (Letcher) owns the tract. The cross I have added to denote the location of the cemetery.

Although the 1898 Atlas shows L. C. Lecher (Letcher) still owns the property this is an error on the map makers part as Charles and Barbara Wohlbold now own it and the neighboring tract.

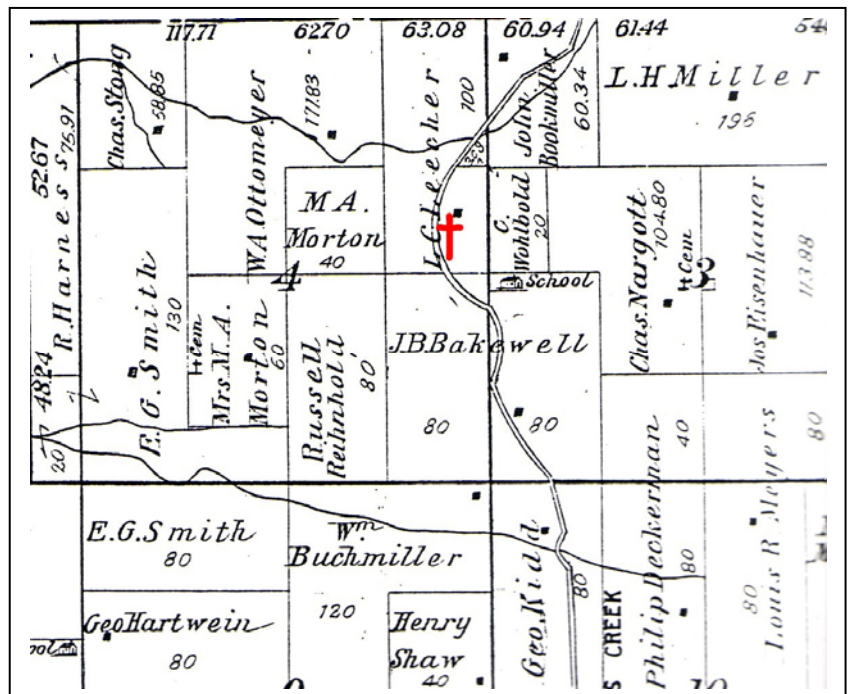

The following two monuments were located in this cemetery;



(Lamb in circle at top)

Heir ruth in Gott
Unser licher sohn

Karl F. Wohlbold

Geb.

Aug 9, 1878

Gest.

Oct. 16, 1884

(German verse on bottom)

(Lamb in circle with cross at top)

Wilhelm Wohlbold

Geb.

9 Aug 1878

Gest.

20 Juli 1887

(German verse on bottom)



Copyright © 2005 Dave Hallemann

This article may be copied for personal use only and must not be used for commercial or profitable purposes, and the author is to be given credit.