

MINER, HORATIO N. GRAVEYARD

By Dave Hallemann



This 20 X 24 foot family cemetery was located in T40 R5 S24 Survey 1219. The original location is forgotten from memory.

38° 12' 53" N / 90° 28' 15" E

While the exact location of the graveyard is unknown it was very possibly pictured at the left along side of Highway CC where the yucca plants are growing.

This cemetery is named for Horatio Nelson Miner whose family was buried there. It was known as Buck Creek Cemetery in some records.

This tract was originally a Spanish Land Grant located in T40 R5 Sections 24 & 25 and T40 R6 Sections 19 & 30. It was entered in the name of Riddick, Thomas F. *under* Dowling, John. It consists of 680.⁵⁶ acres and was confirmed as Survey 1219.

20th June 1854 court orders the Public Administrator to sell on the court house steps the property of desc. Thomas F. Riddick. Wm. S. Howe is the highest bidder for the 680.⁵⁶ acres for \$211.⁰⁰. Transaction recorded in Book M Page 165.

1st August 1858 Wm. S. Howe sells P. Frank Beverly "...25 acres in the NW Corner of Survey 1219..." for \$125.⁰⁰ as recorded in Book P Page 113.

1st October 1863, Philander F. Beverly and wife Elizabeth of Ohio, sell to Horatio N. Miner, "NW Corner of Survey 1219, containing 25 acres, ...also N2/SW fractional Section 24 T40 R5 containing 57.⁸⁹ acre, also the SW/NW S24 T40 R5 containing 40 acres...for \$ 825.⁰⁰. Transaction recorded in Book T Page 32.

5 years later hard times befall the Miners as reported in the local newspaper.

FRIDAY, 26 MARCH 1868
DISASTROUS FIRE –

Mr. H.N. MINER informed us in regard to the burning of his residence, at Hanover, on the 16th inst. There was a high wind at the time, and the house caught fire in the front roof, by sparks from the chimney. Mr. M. was away from home, and his wife being in the back part of the house, did not discover the fire at once. No help was near and everything was burned up. Not a thing was saved, not even a change of clothing for any of the family, nor a particle of provision, or an article of furniture, or a cooking utensil; the library, and in fact everything was burned, leaving him and his family in a destitute condition. \$160 in money was burned, and he has left but \$3.15. Mr. MINER is a Mason and in distress.

According to the 1870 Census; H. N. Miner, was a 56 year old Physician with real estate valued at \$5000, but personal property only valued at \$355.

1st May 1871, Horatio N. Miner and wife Clara A. sell to Halbert Houghton for \$1000.⁰⁰ their property, recorded in Book 3 Page 315.

OBITUARY - MINER.--Died, at her residence, near Hanover, Sept. 5th, Mrs. Clara MINER, aged 55 years.

Three short months ago Mrs. MINER buried her husband, who died of paralysis. For one year before his death he was speechless and helpless, which made him a great charge. During all that time Mrs. MINER was the most patient and faithful nurse I ever knew and to-day that patient and faithful wife and mother lies sleeping beneath the silent tomb. Oh, how sad to stand by those newly-made graves, and see those five orphan children, left without parent or relation within hundreds of miles. Hanover, Sept. 8th, 1878.

1st May 1879, Halbert Houghton a single man sells the property to D. W. Welty, party of the second, and the children of late Horatio N. Miner and late Clara Miner, parties of the third for \$1000.⁰⁰, the land contained in deed Book 3 Page 315 above, in trust for parties of the third. Document recorded in Book 14 Page 370.

Per Permanent Record of Death, on April 21, 1884, Jessie M. Minor was buried in Buck Creek Cemetery, having succumbed to Cerebro spinal meningitis at the age of 3 months 1 day.

17th April 1886, D. W. Welty Trustee; Malcolm Miner and wife Ella; Cora E. Manwarren and husband Ed; George N Miner; May F. Blunt and her husband Thomas; Gracie A. Hanly and her husband; sell the land to John Mathewson, for \$500.⁰⁰, "...tract of land in Survey 1219, begin at the NW corner ...containing 25 acres...there is excepted from this conveyance **20X24 feet to include the graveyard on the 25 acres...**" recorded in Book 28 Page 561.

21st February 1908 John Mathewson and wife Nancy R. sell for \$1.⁰⁰ to Charles Murphy, "...Survey 1219, begin in NW Corner...25 acres...excepted from described lands, 20X24 to include the graveyard on the 25 acres..." Recorded in Book 63 Page 387.

21 March 1921, Charles Murphy sells to Lillian B. Weise, For \$1.⁰⁰, the above tract "...except 20X24 feet long to include the graveyard..." Recorded in Book 91 Page 155.

All subsequent deeds look at contain the 20X24 foot exception.

Finally as fate would have it I was at the History center reading Circuit Court Minutes and came across the following entry recorded in County Court Minutes, June 17, 1946, Book 298 II-B-R, Page 328, Jefferson College History Center....

"Miner, Horatio N., Clara Ida, Jessie Monroe, Robert, bodies removed, from home burial on property of Frederick Weise, in Section 24 Range 5 to County Graveyard, Jefferson County Missouri, by [unnamed] funeral home.

It is my guess that when laying out State Road CC, the new road was laid out on the ridge top and thus this cemetery needed to be moved.

With the above information I feel we can put a name of
Horatio N. Miner Cemetery to this graveyard.



The 1876 Historic Atlas shows H. N. Minor owns the tract. The cross was added to denote the approximate location of the cemetery. Also note that the county road ends on the Wm. Parks tract to the north.

By 1898 John Mathewson has possession of the tract. Again I have added the cross to highlight the approximate location. Note that County Road goes to the west of this tract. I feel the road was again moved in the 1940s and the road went thru the cemetery thus the reason for moving the bodies.

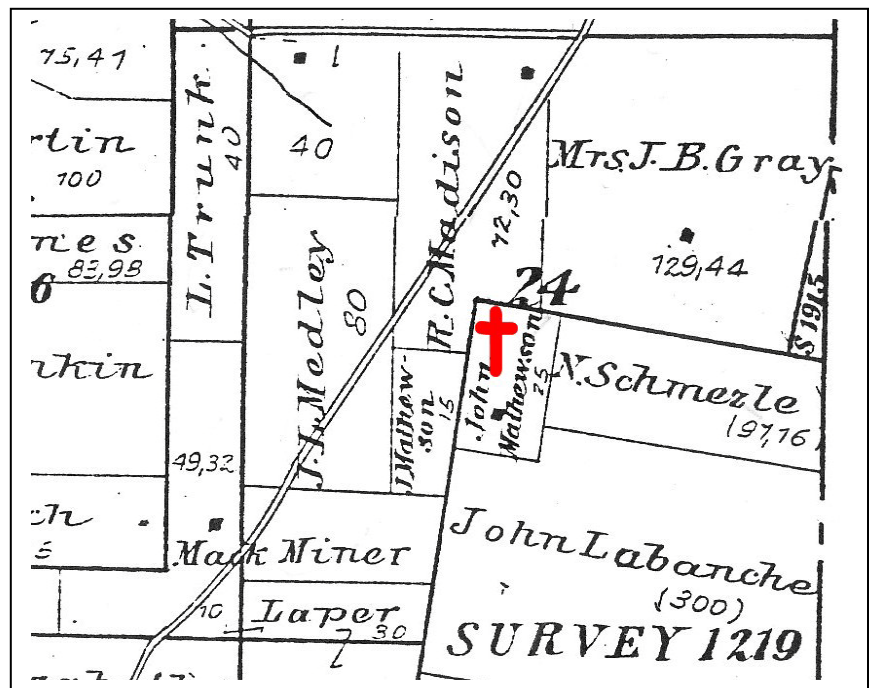

Copyright © 2010 Dave Hallemann

This article may be distributed in any form as long as no fee is charged and the author is given credit.
It is only to be used for personal historical and genealogical purposes.
It is not to be used on any other website or for profit use.