

McClain, Peter Patrick Cemetery

AKA McClain/Rougly

By Dave Hallemann



This hillside family cemetery with its many fieldstones is located in T39 R5 S25 NE $\frac{1}{4}$ of the SW $\frac{1}{4}$.

38° 3' 37" N / 90° 25' 35" W

Originally recorded November 7, 1983 by Jean O'Brien, Frank and Helen Magre. Re-visited 27th December 2006 by Dave Hallemann and Carole Goggin.

This cemetery is on land first entered by Peter P. McClain of Jefferson County Missouri on January 11th, 1855, patent granted 15th April 1857, Certificate #25297, for the E $\frac{1}{2}$ of the SW $\frac{1}{4}$ of T39 R3 S25 and the SW $\frac{1}{4}$ of the NE $\frac{1}{4}$ S36 containing 120 acres.

Peter P. McClain and Ann Lee were married on February 24, 1857 by J. L. McFarland, Minister of the Gospel.

Recorded in Book R Page 248, dated 11th April 1860, Peter P. and his wife Dorthy Ann executed a Deed of Trust to James L. Byrd for \$1000.⁰⁰.

Peter P. McClain dies on June 27, 1862 per monument. Having not paid off the note, on 20th November 1862 the court orders W^m. L. McCormack Administrator of Peter P. McClain desc., to sell as much land as need to satisfy \$950.⁰⁰ plus interest, being sold was the SE $\frac{1}{4}$ and the SE $\frac{1}{4}$ of the NW $\frac{1}{4}$ S26 120 acres; also the W $\frac{1}{2}$ of the SW $\frac{1}{4}$ and SW $\frac{1}{4}$ of the NW $\frac{1}{4}$ Section 25 totaling 320 acres, being recorded in book T Page 633.

The next page, book T page 634, dated November 20th of 1862, Dorothy Ann McClain, widow of Peter P. desc., transfers to James L. Byrd her dower interest in the above mentioned lands. Also on November 20th 1862, in the margin of Book R Page 248, James L. Byrd released the Deed of Trust on the land.

On February 1st of 1865 Sarah H. (Lee) Frazier, the wife of Henry Frazier, a neighbor, and sister of Dorothy Ann (Lee) McClain, dies and is buried in this cemetery. Ten months later, on December 27, 1865, Henry B. Frazier marries Dorothy Ann (Lee) McClain, the widow of Peter. She brings to the union one daughter, Elba, born in 1857.

Earl Emmett McClain's research reflects that Dorothy dies late 1875 or early 1876 with Henry B. Frazier dying about January 1909.

February 20, 1876, Elba A. McClain to Henry B. Frazier, for \$900.⁰⁰, "the NE/NW Sec 36 & SW/NE Sec 36 & the N $\frac{1}{2}$ /NE Sec 36, 160 acres also, W $\frac{1}{2}$ /SE Sec 25 & E $\frac{1}{2}$ /SW Sec 25, T39 R5 total 360 acres as recorded in Book 10, page 319.

Two years later, on July 20th 1878, Henry B. Frazier transfers title back to Elba McClain, same land description as above, recorded in Book 13, page 151.

On October 3rd 1879, Elba marries Amie L. Rouggy at Lee Ashcraft's home in De Soto, Missouri, per Earl Emmett McClain papers.

Elba Rouggy died on March 30, 1936 and Amie Rouggy died at home on April 13, 1944, both being buried at Charter Church Cemetery.

Recorded in Book 202, page 503, on April 25, 1952, the heirs of Elba and Amie; Julia A. Watts and her husband Lancie, Eugene L. Rouggy and his wife Olive, Iva R. Boyce and husband William, Stella England and her husband O.H. (Oscar Hart) England, and Mable E. Toulouse and her husband Harve, transfer their interest to their brother Clarence E. Rouggy, in "W^{1/2}/SE; E^{1/2}/SW; NW/SW; and the S^{1/2}/NW except that part of the NW corner lying west of branch, all in Section 25, also SE/NW; NE/SW in Section 26 lying east of the branch, also SW/NE; N^{1/2}/NE; NE/NW Sec 36 totaling in all 468 acres." As recorded in Book 478 page 732.

Recorded in Book 454 page 946, dated February 1st 1971, Clarence E. Rouggy, a single person, transfers title to Wade Allen Syndications, Inc. the above mentioned 468 acres.

The parcel land where the cemetery is located was in the Peter McClain family for almost 120 years, from 1855 until 1971 and the adjoining tract settled by Jeremiah Sr. his father even longer.

Although no deed "excepting out" this cemetery could be located I feel the official name should be "**Peter P. McClain Cemetery**" as he was the first person to purchase this tract from the U.S. Government in 1855. He and his descendents are buried there and according to the Earl Emmett McClain papers so are Jeremiah Sr. and his wife Elizabeth, parents of Peter P. McClain who homesteaded an adjoining tract.

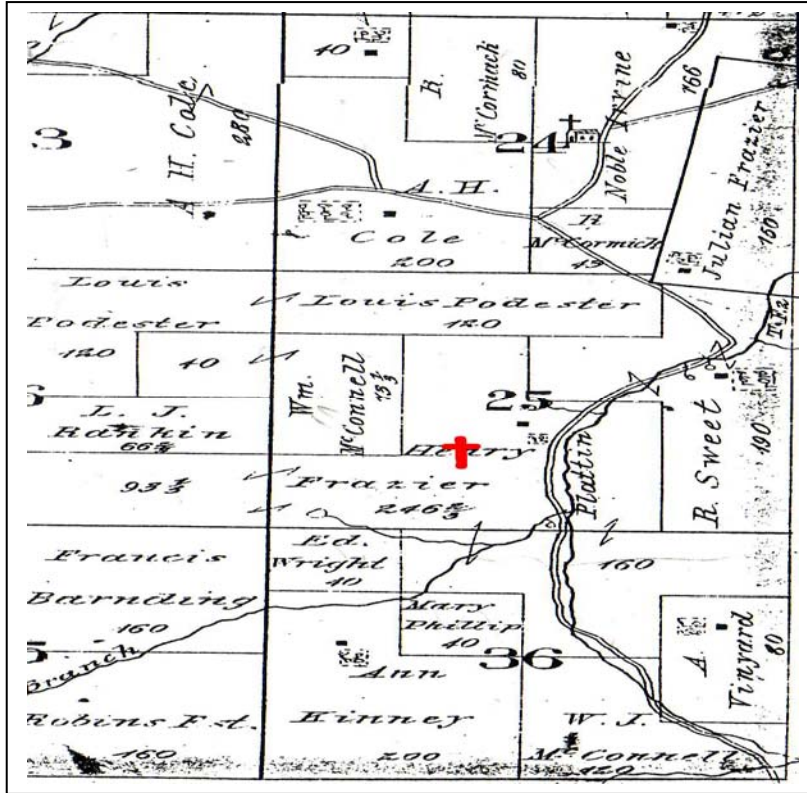

As can be seen in the picture at left, Henry Frazier's name shows on the 1876 Atlas as he is now the husband of Dorothy McClain Frazier.

The cross I added to the photo to denote the approximate location of the cemetery.

In 1898 the tract has been in the possession of A. L. Rougley, the husband of Elba (McClain) Rougley.

As before, I added the cross to show location.

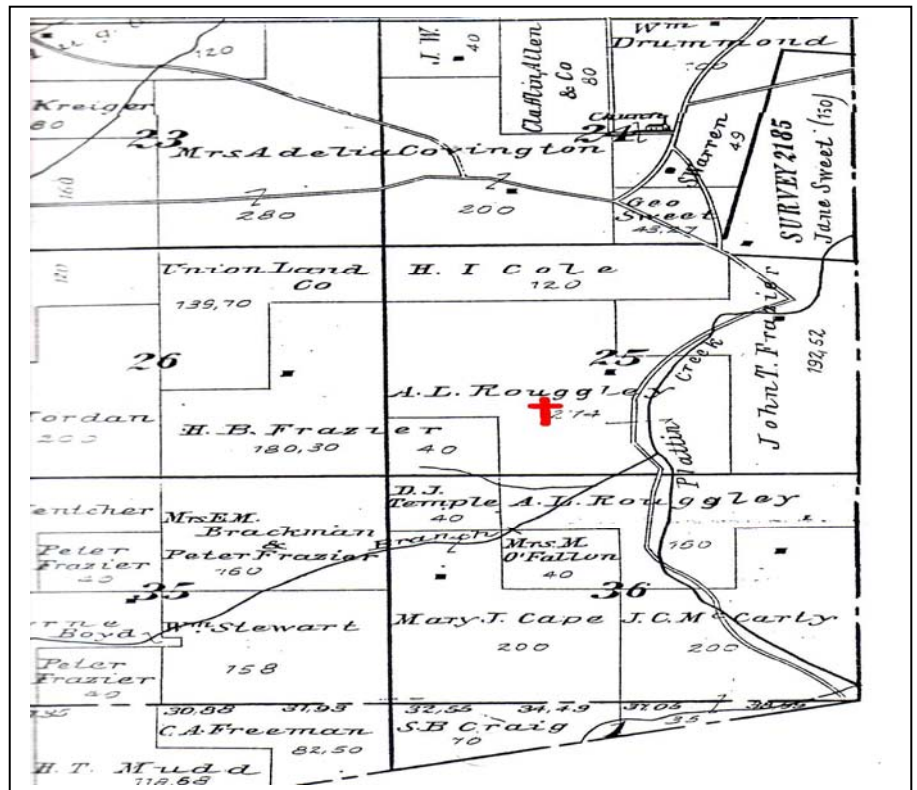

The following persons are listed on the monuments in this cemetery. There are also many fieldstone markers;



Weep Not For Me
Here Is Rest In Heaven

Peter P. McClain

Died
June 27, 1862

Aged
50 Years 19 Days

Footstone P. P. M.

(Bottom of Peter P. McClain Monument,
Hand Carved)

Also
Elizabeth daugh
of P. and D. A. **McLain**
Died Jan 23, 1863
Aged 9 mo 8 dys (?)





May We Meet Again
Finger pointing to crown with
same verse

Sarah H.

Wife of
H. B. FRAZIER

Died
February 1, 1865

Aged
18 Years

Rosenbough
St. Louis
(Monument Maker)

Footstone S. H. F.

In Memory of

Abigail

Wife of
A. T. PORTER

Died
February 6, 1844

In the
**29th Years of
her age**

Footstone A. P.





Rouggly Home about 1898. Photo in possession of current property owner. We believe the people are from l to r; Iva, Elba (McClain), Stella, Mabel, Julia Ann, Amie, Eugene, and Clarence Rouggly

From an unidentified researcher, we had the following in our records;

- Frazier, Sarah H., d. Feb. 1, 1865, nee Lee, wife of H. E. Frazier, sister of Dorothy A. McClain
Frazier, Dorothy A., b. 1838, d. 1875/6, nee Lee, widow of Peter Patrick McClain, wife of Henry B. Frazier, owned and was living on farm where cemetery is, when she died
Frazier, Allie Edna, d. July 10, 1875, daughter of Henry & Dorothy Frazier, source De Soto Public Library, Probate Court Proceedings, 1875, P. 260, obituary Jefferson County Democrat
McClain, Leonidas Rudolph, b. 1860, d. 1870, son of Peter P. & Dorothy A. (Lee)
McClain, Jeremiah, b. 178?, d. 1836, source: Earl E. McClain papers II, p. 267, 292
McClain, Elizabeth Alexander, b. 179?, d. 1830, daughter of M/M Alexander, source: Earl E. McClain papers II, p. 267, 292
McClain, Elizabeth Rebecca, d. Jan 23, 1863, daughter of Peter & Dorothy A. McClain, Name & date across bottom of Peter McClain's tombstone
McClain, Peter Patrick, d. June 27, 1862, 50 yrs 19 dys, wife Dorothy A. (nee Lee) McClain Frazier
Palmer, Isabella, b. 1810, d. 1850, daughter of Jeremiah & Elizabeth McClain, Probably buried here - Source: Earl E. McClain papers II, p.290.
Porter, Abigail, d. Feb. 6, 1844, Said on tombstone "wife of A.T. Porter in the 29th year of her age"
Rouggly, Unnamed, b. & d. Aug. 13, 1883, stillborn, Source: Family Bible, in possession of A. Wayne Rouggly, Festus (RR)
Stewart, William R., d. late 1860s, A Soldier (Earl E. McClain papers II, p. 292); Clarence E. Rouggly, quoted in Walnut Hollow Farm article

Copyright © 2007 Dave Hallemann

The article contained on these pages is intended for personal historical/genealogical research and educational purposes only. The information may be copied as long as the author is given credit. Duplication of any of this data in any form for commercial use, or a fee charged, without prior written consent of the author is expressly prohibited.