

Buren Cemetery

By Dave Hallemann



This beautiful cemetery with its crumbling stone walls is located in T40 R5 S9 Survey 423 NE¼ just below a lake dam.

38° 12' 53" N / 90° 28' 15" E

The cemetery is named for Paschal H. Buren born May 27, 1801 and died October 5, 1870. The earliest burial date in this cemetery is Lucy Honey, daughter of Paschal on November 5 1851.

This tract of land was first entered into record as Original Land Survey 423 issued to

William Null SR. containing 600 arpents or 510.42 acres, situated on Joachim Creek.

William Null SR. and wife Dorothy sold this partial tract to Rudolph Haverstick Jr. "...120 acres part of 510 acres originally confirmed to William Null SR...." for \$400.⁰⁰ on 19 February 1825 as recorded in Book B page 207.

Rudolph Haverstick and wife Sarah next sold the 120-acre parcel to James Stephens on 27 November 1826 as recorded in Book B page 334.

James Stephens and wife Elizabeth next sold the land to Jonathan Huskey SR., all of Jefferson County, for \$650.00 on 29 December 1829, recorded in Book C page 130.

I *assume* that the tract was surveyed near this point, possibility by Paschal H. Buren, and the true amount of land was 130 +/- acres instead of 120 and became Survey 510 instead of the larger original Survey 423. I could not locate Survey 510 in the records at the courthouse, however it exist somewhere.

Paschal H. Buren of Washington County, Missouri, purchased the property from Jonathan Huskey SR. *of Monroe County, Illinois*, "...130 acres situated on Joachim Creek originally confirmed to William Null SR. containing 510.42 acres...for \$550.⁰⁰ *in silver* full amount paid 22 November 1836..." Jonathan Huskey signed the document with his mark (X). Both Paschal and his wife Catherine (Kate) could sign their names, as recorded in Book D page 170 of the Jefferson County land records.

On 27 November 1858 Madison Graham and James Ogle put up a \$500.⁰⁰ bond to the State of Missouri to have Paschal H. Buren appointed a Notary Public, as recorded in Book P page 74.

While running records on Paschal I came across a document that seems unusual. Recorded in Book S page 598 a deed where "...P. H. Buren and in name of wife **Nancy K...**" sold a piece of property. This could be another P. H. Buren or Nancy K. was Paschal's deceased wife before Catherine. Another deed I saw relates that P. H. Buren was a County Surveyor. Another list "...P. H. Buren and wife Cate...to daughter Sallie E. now Warne" recorded in Book T page 265.

It is alleged that slaves are buried outside the walls of this cemetery. This could very well be true as slaves most often were buried outside the cemetery and it seems Paschal H. Buren was a slave holder as related in Goodspeed's History on page 405;

"State vs John, a slave. On 7th February 1852 John a slave belonging to Paschal H. Buren, clubbed and killed "Free Jack", a free colored man, and at the following May term of the circuit court he was indicted for the crime of murder. On being arraigned for the trial he pleaded "guilty" whereupon the court pronounced the following sentence; "that said defendant receive on his bare back thirty-nine stripes and that the sheriff execute the sentence." The cost of prosecution were charged to Mr. Buren, the owner of the slave. In this case a particular characteristic of slavery is observed. Jack, the free Negro, represented no value, while John the slave, did represent value, and his execution for the crime would have been the destruction of so much property-hence the apparent reason for his being allowed to plead guilty and to escape with a whipping, which is presumed, did not materially injure the property."

On page 452 of Goodspeed, P. H. Buren was appointed school commissioner prior to 1854. And again on page 466 Paschal H. Buren was one of the first people to enter a tract of land in Township 40 Range 1, in Washington County, in the 1830s.

As can be seen Paschal H. Buren was a prominent citizen of the county, being a surveyor, school commissioner, and Notary Public.

In a deed recorded in Book 3 page 314:

"I P. H. Buren of Jefferson County do by these presents, bargain and grant unto my dutiful daughter Matilda C(?) her portion of my estate which I consider an equal share and for many valuable services rendered to her parents for many years the following described real estate (to wit); the fraction of land I have lived so many years 120 acres NE part survey 510 and all the land I own in Sec 4 T40 R5 east of the 5th principal Meriden in Jefferson County Mo. about 146 acres more or less in both tracts. To have and to hold during her natural life and to the heirs of her body forever, if any, and if none it shall descend, I mean the home farm of 120ac more or less, to my grand daughter L(?) S. Honey, to be a legacy to her and to the heirs of her body forever, and that part in section 4 of 146ac shall descent from Matilda to Maggie Warne, my grand daughter if living at the time, if not to her brother Willie. Also all money, debt, and dues to me and all crops, stock of all kinds, tools, in fact all in the houses and on the farm, after the death of her parents, and to pay all just debts, and all the stock and crops and whatever may be on the farm descends with the title of the land the money and all furniture Matilda can dispose of herself verbally by gift to any of my grand daughters and the gift shall be good, now I intend my wife to have charge of all after my death during her life.

In testimony whereof I set my hand and seal 8th day of June 1869.

P. H. Buren {seal}

As can be seen in the above document Paschal combined a deed transfer and his will into one instrument.

On 28 September 1876, as recorded in Book 11 page 126, Matilda "...at present residing at Buren's Store P. O., Tenn..." sold the tract to Stella L. Gale and husband.

It is *my opinion* that Stella Gale may have been a relative of Paschal H. Buren's. Quite possibility the married grand daughter L. S. Honey mentioned in the will, or another grand daughter or relative as she in her deed exempts the Cemetery, as recorded in Book 12 page 60.

Stella Gale and her husband Arthur of St. Louis City, sold the property, NE part of Survey 510 containing 120 acres, to Monroe Whitehead of Jefferson County for \$1000.⁰⁰. "...said land being the farm home of Paschal H. Buren, deceased in his life time and interest in which of Matilda C. Buren was conveyed to the said Stella L. Gale by deed dated 28 September 1876...said party of the first part hereby expressly excepting from the operation of this conveyance and the party of the second part by acceptance of this conveyance agreeing and assenting thereto and reserving from said conveyance of said tract of land **one hundred and five feet in width and by two hundred and ten feet in length to include the burial ground whereon are the graves of said Paschal H. Buren, deceased, and others of his family and relatives**, the said ½ acre so reserved as aforesaid shall not pass by the conveyance but shall remain the property of Stella L. Gale..."

One interesting feature of this cemetery is the "stile" steps one must ascend and descend to enter this cemetery. One reason I have heard for these steps was a woman could mount and dismount her horse by riding up close to the steps, thus eliminating the need for a "leg up". It could also be used to keep cattle out.



As can be seen by the photo of the inside of this cemetery, repairs need to be done to the stone wall and tree removal.

Searching Marriage records turned up the following;

John Hearst married a Nancy Buren on 17th November 1853, Horace Honey married Lucy Buren 2nd December 1846, Lucy dies 5 years after their marriage in 1851, Horace Honey married Margaret Buren on 18th May 1853, Horace Honey died in 1855. And finally Charles Warne married Sarah Buren 27th February 1860.

I don't know how these people relate to each other. I offer this information for persons researching the Buren family tree.



As can be seen in the picture at left, by 1876 Paschal Buren has passed on and M(atilda) Buren is now in possession of the property. The cross I added to the photo.

By 1898 Dr. J. M. Kershaw has become owner of this tract and adjoining lands. As before I added the cross to show location.

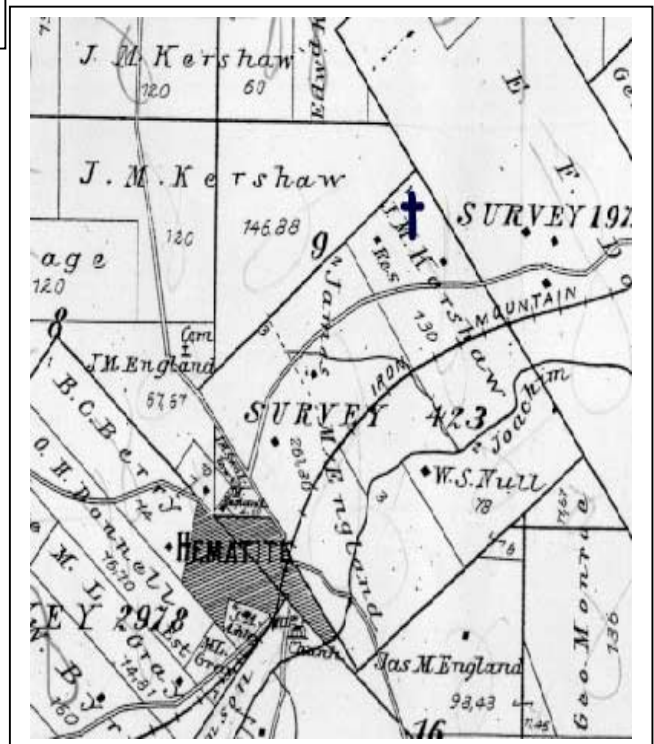

The following people are listed on the stones in this cemetery, if standing on the steps beginning to the left and moving to the right;



Horace Austin Honey

“Who closed a blameless life on the 3 April 1855, while the earth was beautiful still to his eye he sank into her bosom to rest. Aged 30 Years”

Lucy
daughter of
P. H. & C. Buren
and wife of
H. A. Honey
was
Born February 16, 1828
Converted Jan. 1844
Sanctified May 1849
Fell asleep Nov. 5, 1851
*“And will awake at the
resurrection of the just.”*

Footstone L. H.





In
Memory of
Paschal H. Buren
Born
May 27, 1801
Died
October 5, 1870
“He (went to?) the Christian
home. There the wicked
cease from troubling,
and there the weary be
at rest.
JOB 3, 17”

Footstone P. H. B.

In
Memory of
Kate King
Wife of
Paschal H. Buren
Born
February 4, 1801
Died
August 27, 1872
“When Christ who is our
life shall appear, then shall
we appear with him in Glory.”

Footstone K. K. B.

