

## Jeremiah McClain Cemetery

By Dave Hallemann

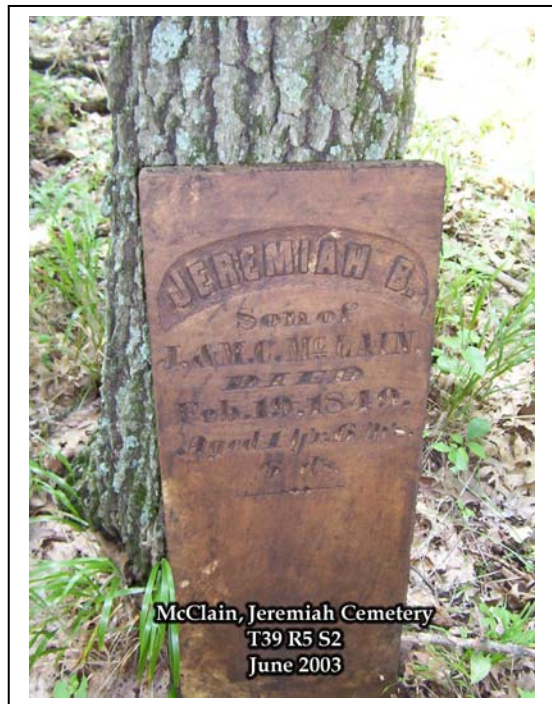

This secluded cemetery is located in T39 R5 S2 SE $\frac{1}{4}$  of the NE $\frac{1}{4}$  of Lot 3.

38° 8' 0" N / 90° 26' 3" W

This cemetery was visited June 20<sup>th</sup>, 2003 by Jerry McKee, Sharon Uding, Tina Reifsteck, and Dave Hallemann.

The unusual coloration of the monument at left is probably due to being buried for a long period of time and absorbing minerals from the rich soil. This monument was not found on the 1983 survey. There were rows with many fieldstones present in them. This was a typical family cemetery.

This tract was first entered into record in Original Entries Book 2 under Henry Smith on July 16<sup>th</sup>, 1833, the E $\frac{1}{2}$  of Lot 3 T39 R5 S2 containing 40 acres, Certificate #3858.

22<sup>nd</sup> August 1834 after having the tract for one year, Henry Smiths sells the W $\frac{1}{2}$  of the E $\frac{1}{2}$  of Lot 3 S2 T39 R5, containing 20 acres to Thomas Strickland for \$75.<sup>00</sup> as recorded in Book C Page 506.

On the same date Henry Smith sells the E $\frac{1}{2}$  of the E $\frac{1}{2}$  of Lot 3 T39 R5 S2 to Braxton Pollard containing 20 acres, recorded on the next page in Book C Page 507.

Six months later on 18<sup>th</sup> February 1834 Braxton Pollard and his wife Harriet sells his 20 acres of the E $\frac{1}{2}$  of the E $\frac{1}{2}$  of Lot 3 T39 R5 S2 to Thomas Strickland for \$80.<sup>00</sup> recorded in Book D at page 2.

5<sup>th</sup> day of April 1839, Jeremiah McClean purchases the E $\frac{1}{2}$  of Lot 3 of the NE $\frac{1}{4}$  of T39 R5 S2 containing 40 acres and the W $\frac{1}{2}$  lot 3 of the NW $\frac{1}{4}$  S1 T39 R5 containing 40 acres from Thomas Strickland and his wife Eleanor for \$500.<sup>00</sup> being recorded in Book E Page 268.

Jeremiah prospers and in the 1850s he begins purchased adjoining acreage as it became available until by 1876 has he has amassed 410 acres.

In 1890 Jeremiah McClain dies and 4 years later in 1894 his second wife Mary Jane also passes.

Five days later on January 31<sup>st</sup>, 1894, we find J. T. McClain and wife Martha; E. S. McClain and wife Anna B.; John E. McClain and wife Susan; Charles R. McClain and wife Minnie B.; Clarence E. McClain and wife Mary D.; Mary A. Thompson and her husband

*Jeremiah McClain Cemetery*

George; Ella M Smetzer and her husband David; Horace C. McClain, and Sarah C. McClain all of Jefferson County sell their 9/11<sup>th</sup> interest in “W<sup>1</sup>/<sub>2</sub> Lot 3 NW<sup>1</sup>/<sub>4</sub>, 140 acres; N part W<sup>1</sup>/<sub>2</sub> Lot 2 NW<sup>1</sup>/<sub>4</sub> section 1, 10 acres; N part E<sup>1</sup>/<sub>2</sub> Lot 2 NE<sup>1</sup>/<sub>4</sub>, 10 acres; E<sup>1</sup>/<sub>2</sub> Lot 3 NE<sup>1</sup>/<sub>4</sub> 40 acres...” selling their 1/11<sup>th</sup> interest for \$2043.<sup>00</sup> to W. N. B. McCarty, as recorded in Book 41 Page 301.

On 23<sup>rd</sup> May 1896, E. S. McClain guardian of Reed McClain of unsound mind, sells Reed’s 1\11<sup>th</sup> interest in the property to W. N. B. McCarty, recorded Book 43 Page 616.

The next deed I located was on 7<sup>th</sup> October 1937 from Eva McCarty to A. R. McKee, \$1.<sup>00</sup>. “... E<sup>1</sup>/<sub>2</sub> Lot 3 NE<sup>1</sup>/<sub>4</sub> ...”

Although no deed was found “excepting out” this cemetery, with the above evidence and the fact that there are many McClain cemeteries, I feel we can “officially” call this one *Jeremiah McClain Cemetery*

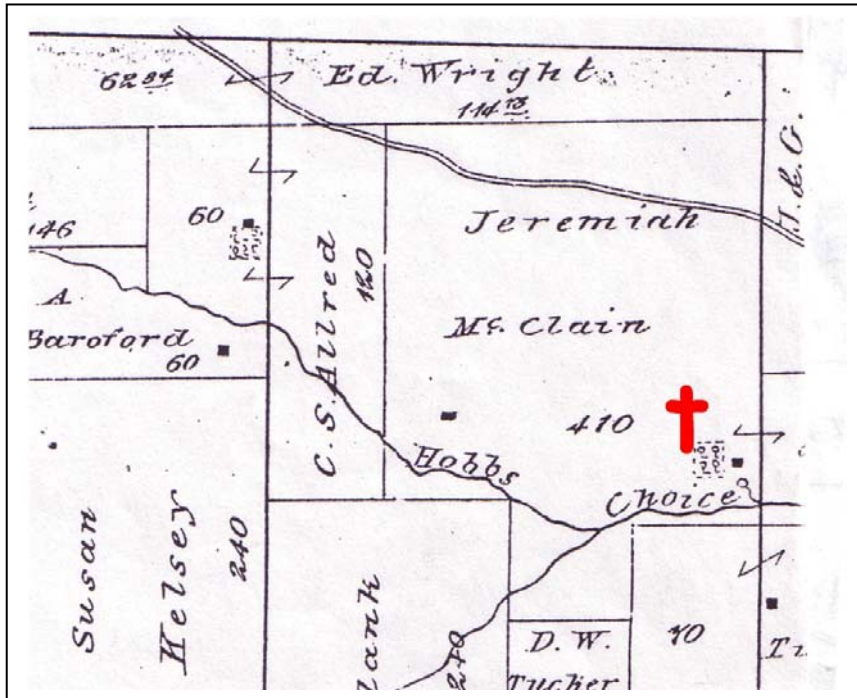

The 1876 Historic Atlas show Jeremiah McClain owns the tract after purchasing it various smaller tracts. The cross I have added to denote the approximate location of the cemetery.

By 1898 W. N. B. McCarty has possession of the tract. Again I have added the cross.

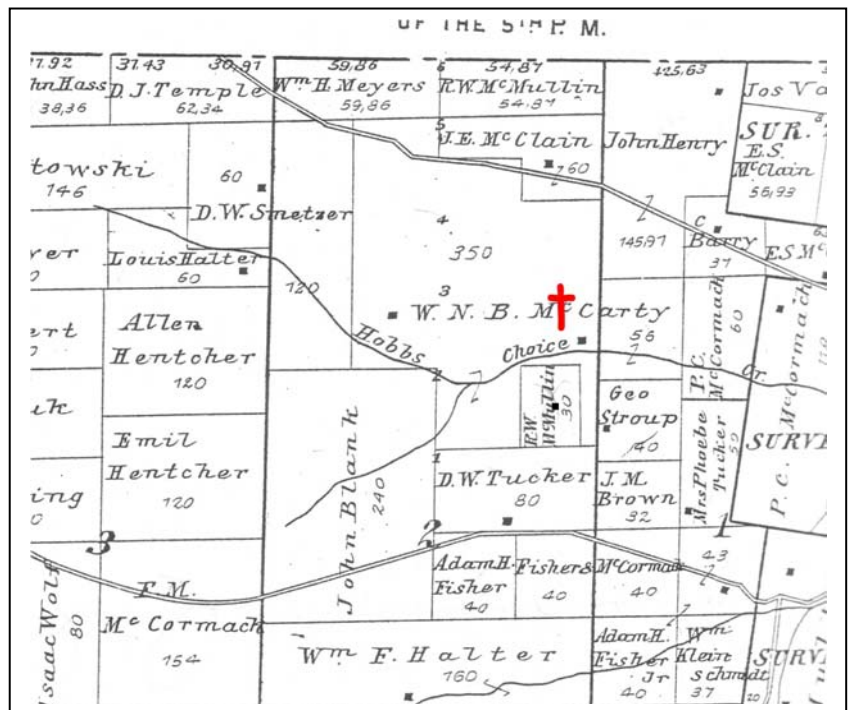

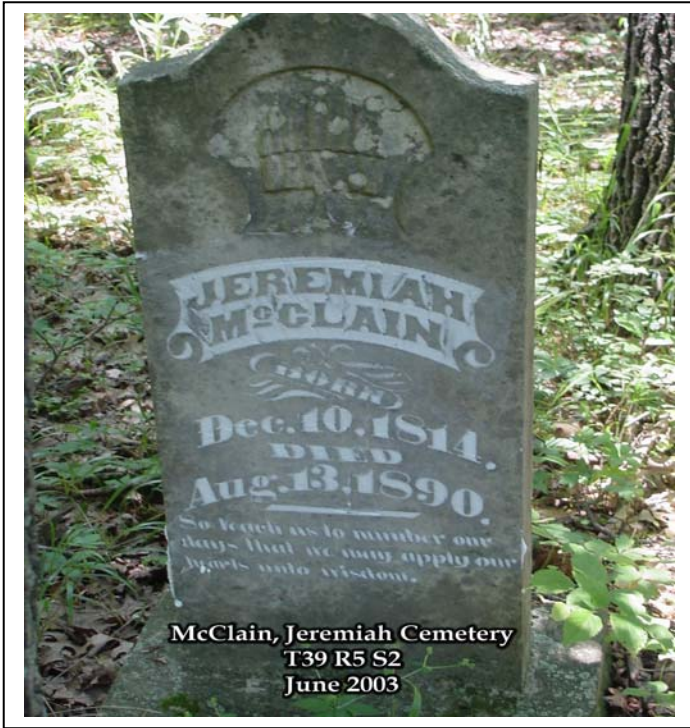

## Jeremiah McClain

Born  
December 10<sup>th</sup>, 1814

Died  
August 13<sup>th</sup>, 1890

*So teach us to number our  
days that we may apply our  
hearts into wisdom.*

(Weeping Willow in circle at top  
footstone J. McC.)

## Mary C.

Wife of  
**Jeremiah McLain**

Died  
January. 26<sup>th</sup>, 1859

Aged  
37 Yrs 6 Mos 4 Ds

*The soul of our sister has gone  
To brighten the triumphs above  
Exalted on Jesus throne  
And clasped in the arms of his love.*

(footstone M. C. M. L.)

(this stone was completely buried and  
found by Tina Reifsteck)

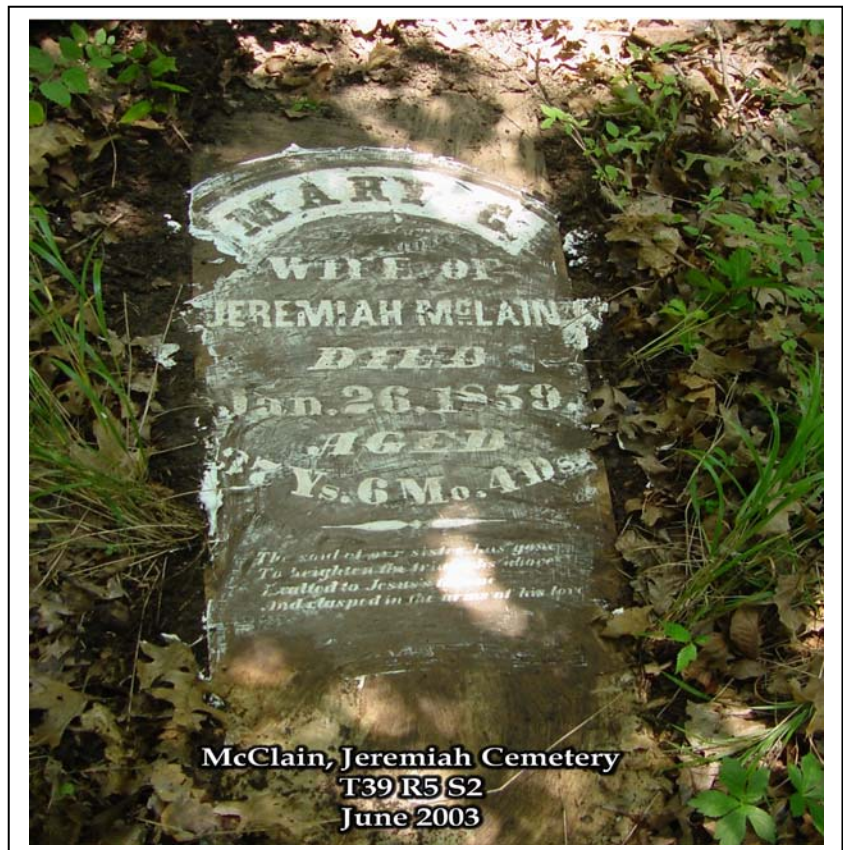

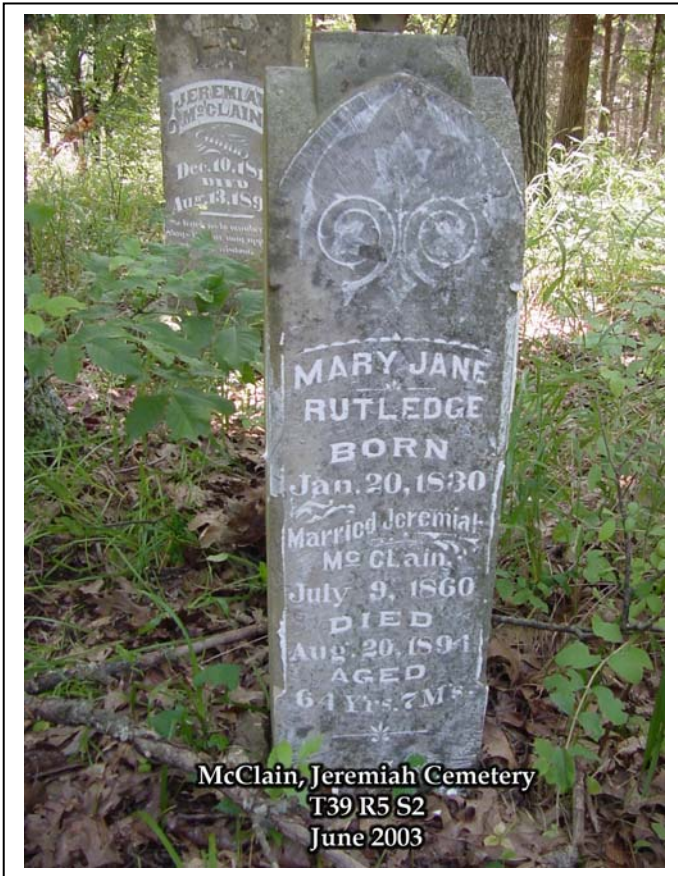

**Mary Jane  
Rutledge**

Born  
January 20<sup>th</sup>, 1830

Married Jeremiah  
McClain  
July 9<sup>th</sup>, 1860

Died  
August 20<sup>th</sup>, 1891

Aged  
64 Yrs 7 Ms

(footstone M. J. Mc)

**Sarah C. McClain**

Born  
January 9<sup>th</sup>, 1864

Died  
February 13<sup>th</sup>, 1906

(footstone S. C. Mc)

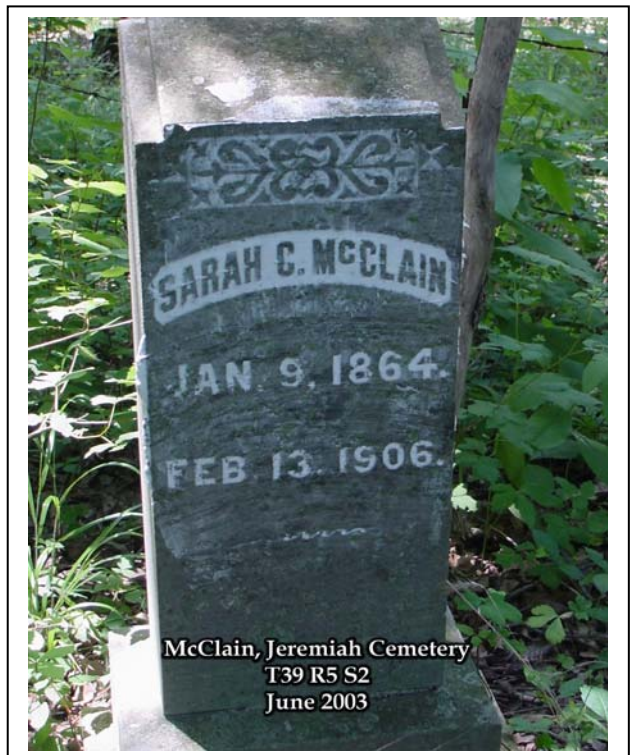

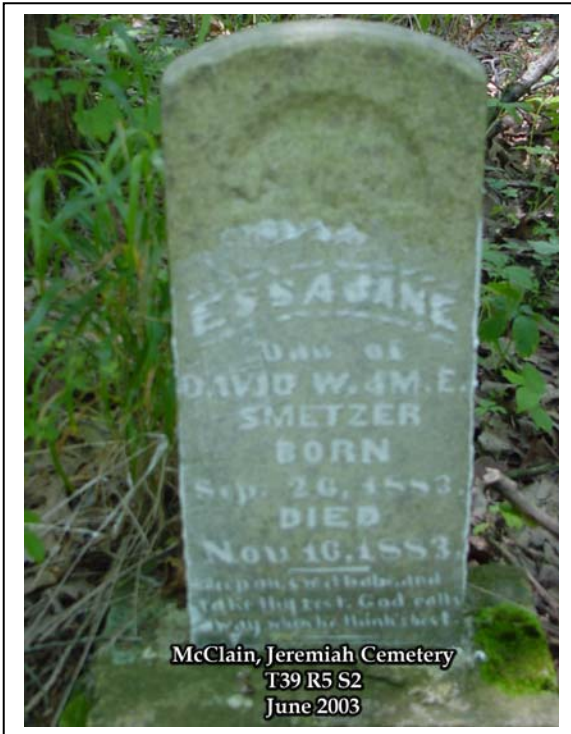

## Essa Jane

Daughter of  
David W. & M. E.  
**Smetzer**

Born  
September 26<sup>th</sup>, 1883

Died  
November 16<sup>th</sup>, 1883

*(Sleep on, sweet babe and take thy rest. God calls away when he thinks best.)*

Lamb in circle on top

## George W.

Son of  
J. & M. C. McLain

Died  
June 23<sup>rd</sup>, 1848

Aged  
3 y's. 28 da.

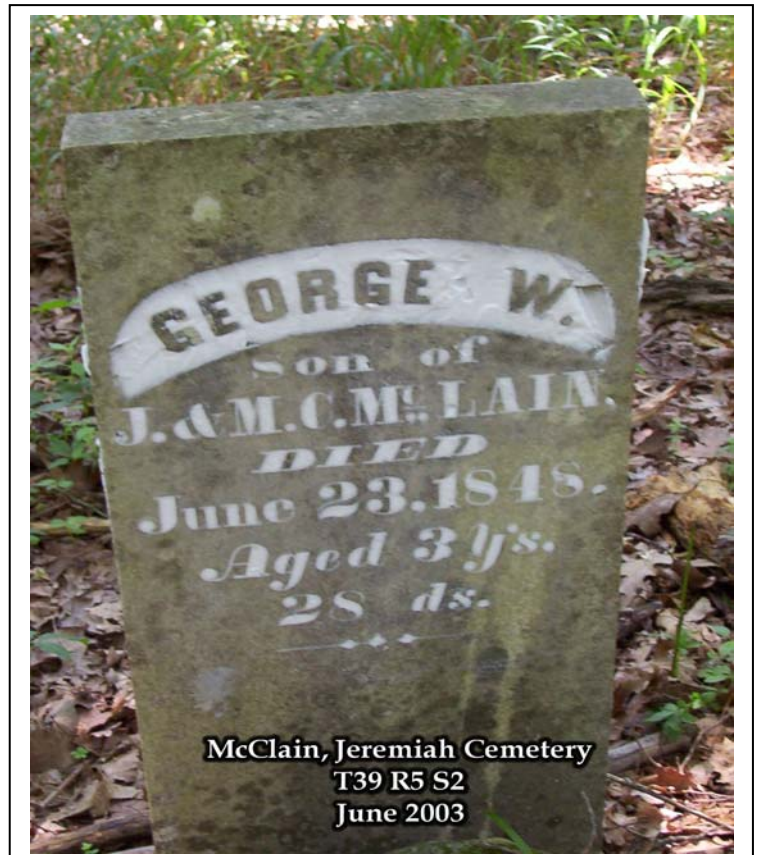

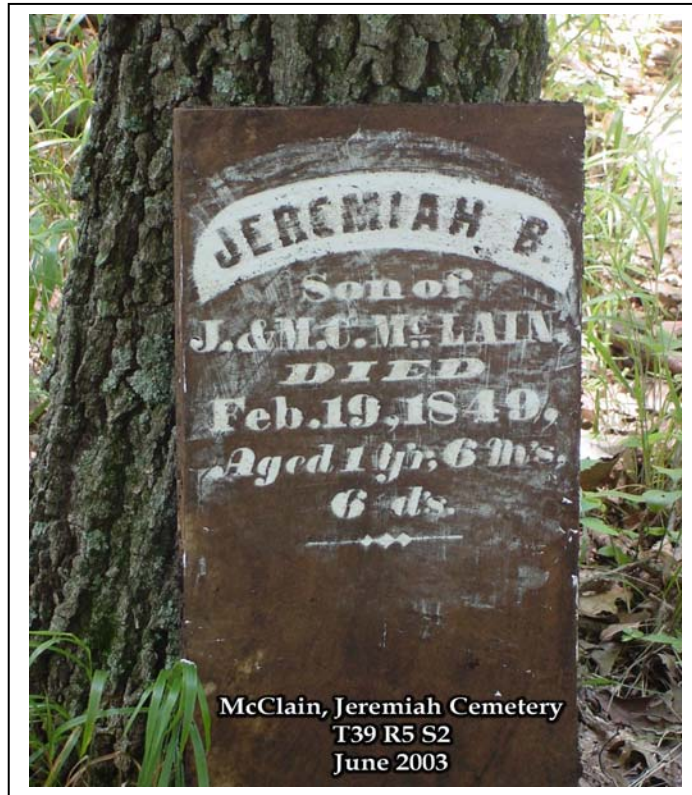

## Jeremiah B.

Son of  
J. & M. C. McLain

Died  
February 19<sup>th</sup>, 1849

Aged  
1 y'r 6 m's 6 ds

*This monument was missed in the 1983 recording of this cemetery. It was buried about 3 inches and found by Dave Hallemann.*

### *Additional information on these families;*

1850 Census shows Jeremiah McClane, 35 male farmer; Mary C., 28 female; James F. 11 year old male; William R., 9 year old male; Elizabeth J. 7 year old female; Emmitt S. 6/12 year old male; and Blue, John F. 7 year old male.

1860 Census shows McLain, Jeremiah, 45 year old male farmer; Mary C. is not shown as she has fallen asleep being confirmed by the notation on Mary Jane's monument stating she was married in 1860; James Thomas, a 21 year old male; William R., 19 year old male; Elizabeth, 17 year old female; Emmett Smith, 12 year old male; Harris Cope, 10 year old male; John E., 6 year old male; and Mary 3 year old female.

1870 Census we find McLain, Jeremiah, 56 year old male farmer; Mary Jane, 40 year old female, keeps house; Emmitt S. 19 year old male, working on farm; Horace c., 18 year old male, working on farm; John E., 16 year old male, working on farm; Mary, 13 year old female; Margaret E., 8 year old female; Sarah C., 6 year old female; And Charles, 4 year old male.

1880 Census McLain, Jeremiah, 65 year old male farmer; Mary, 50 year old wife, keeping house; Ella, 18 year old daughter; Sarah, 16 year old daughter; Charles, year old son; Clarence, 9 year old son; and Lanning, Martha, works in house.

Jefferson Democrat, Hillsboro, Jefferson County, Missouri, FRIDAY, 30 MARCH 1877  
FINAL SETTLEMENT - NOTICE is hereby given that the undersigned Guardian of Ennett(?), Horace, John and Mary McCLAIN, has filed with the Probate Court of Jefferson county, Mo., a true and correct statement of my

*Jeremiah McClain Cemetery*

accounts with said wards, and that at a term of said Court, to be held at Hillsboro, on the second day of July, 1877, I shall apply for a discharge as such guardian. Jeremiah McClain, Guardian of said minors.

Reed McClain died about May 1, 1910. Reed McClain had been an invalid for many years and died in a hospital where he had been for a long time.

Porter, Mary - died November 25, 1887, at her residence on Platin, at age 75. She was the daughter of early settler Jeremiah McClain. She is survived by her husband Samuel Porter, and four children.

McCarty, N. Bonapart married McClain, Jane E., Tuesday April 1, 1862. In the above abstract we find that the McClain heirs sell their 9/11<sup>th</sup> interest in the property. With Reed McClain's 1/11<sup>th</sup> interest that makes 10/11<sup>th</sup>. The final 1/11<sup>th</sup> can be explained by the above Jane E. McClain who married N. Bonapart McCarty was an heir and had 1/11<sup>th</sup> interest. He is the W. N. B. McCarty who owns the property per the 1898 Atlas.

"Uncle" W. B. McCarty died November 14, 1908; Mrs. W. B. McCarty died November 17, 1908. This married couple lived to a ripe old age, and passed from earth to their reward within three days of each other. They always lived in this community, raised a large family and were a good citizen to the community at large, lived successful lives and in their death leave a rich legacy in good deeds done to their neighbors and children. They died in the Christian faith and in the high esteem of all who knew them.

*(Some observations: All the McClain graves seem to have monument. The two rows of fieldstones could be the burial sites of the McCarty's, as their sites are unknown, they died 3 days apart, and they owned this tract from 1894 to at least 1937. Most fieldstones appear to be adults with a distance between the head and footstones of 5 to 6 feet. There are some however that is probably a child due to the shortened distance. This cemetery is in a wonderful state of preservation due to its remote location and the obvious protection of the property owners. The monuments that were buried were not broken but appear to have simply fallen over and become buried. Sarah C. McClain was buried in 1906, after the property was sold, but still in possession of her sister and her husband.)*

*Copyright © 2003 Dave Hallemann*

*This article may be distributed in any form as long as there is no fee charged,, and the author is given credit.*