

# Henry Grob Graveyard

By Dave Hallemann



This graveyard with its lone monument is located in T40 R5 S21 NE $\frac{1}{4}$  of the S $\frac{1}{2}$  of the SW  $\frac{1}{4}$  in the middle of a wooded area.

Visited 23<sup>rd</sup> March 2014 by Dave Hallemann and Shawn Reece.

38° 10' 30.55" N / 90° 28' 32.29" E

The tract of land the graveyard is located on was first entered by Ruel J. Powell, and recorded as Certificate #27,721 on 10<sup>th</sup> June 1857, for the...S $\frac{1}{2}$  of the SW $\frac{1}{4}$  of T40 R5 21...all tracts totaling 290.<sup>94</sup> Acres.

On 8<sup>th</sup> February, 1858, Ruel Powell deeds the lands to Lavina Fulton, for love and affection he has for his sister, in T40 R5 S21 & 22...in all 441.<sup>79</sup> acres, as recorded in Book O at Page 273.

31<sup>st</sup> January 1865, William H. Fulton and his wife L. C. of Little Rock,

Arkansas, to Henry Grob of St. Louis County, "...S $\frac{1}{2}$  of the SW $\frac{1}{4}$ , Section 21, Township 40 Range 5, containing 80 acres...for \$400..." Transaction being recorded in Book 2 Page 268.

Finally on 10<sup>th</sup> March 1894, M. J. Grob; John H. Grob; Thomas F. Grob; and Ella Grob transfer title to Sallie and William F. Grob, "...80 acres, 1/10<sup>th</sup> acre reserved for graveyard where Henry Grob and wife are now buried..." Transaction being recorded in Book 40 Page 459.

With this deed we can put an official name of *Henry Grob Graveyard* on this site.

Henry dies 3 days before Christmas in 1887 per monument. However the tragic story unfolds the previous day;

*Jefferson Democrat*

*Hillsboro, Jefferson, Missouri*

*WEDNESDAY, 4 JANUARY 1888*

The family of Henry GROB, of near Hematite, had a sad Christmas. Mr. G. had been in St. Louis on business, and intended returning home on Wednesday evening. Through mistake he got onto a Chicago and Alton train, and did not discover his error until the train neared the entrance of the tunnel, when he attempted to jump off and was thrown against the side of the

tunnel with such force that he received injuries from which he died the next day in the City Hospital. His remains were brought home for interment on Saturday. Mr. GROB was a useful citizen, and leaves a wife and five children.

St. Louis GLOBE-DEMOCRAT

Thursday Morning December 22, 1887- pg 4 Col 7

Henry Grob, a farmer residing at Hermitage, MO was picked up at the tunnel entrance, Eighth and Poplar streets, last night, with his head badly crushed. He is supposed to have been hit by a passing train he was trying to board, or else to have fallen from a moving train.

St. Louis Post Dispatch

Thursday December 22, 1887-pg 12 Col 3

LOCAL NEWS

Henry Grub, 57 years of age, living at Hematite, MO., was found in an unconscious condition at the mouth of the tunnel on Poplar street last night. He had a wound in the forehead, but could not give an account of how he received it. It is supposed that he was struck by an engine while passing up Poplar street.

St. Louis GLOBE-DEMOCRAT

Friday December 23, 1887

LOCAL BREVITIES

Henry Grob, the old German who was injured in some mysterious manner at the entrance to the tunnel, Eighth and Poplar streets, Wednesday, died at the City Hospital yesterday afternoon. The deceased had a ticket to his home in Hematite, MO.

State of Missouri,  
City of St. Louis

December 23rd 1887

H. C. Dalton M. D., being duly sworn testifies as follows: I am Superintendent and Surgeon in Charge of the St. Louis City Hospital.

"Henry Grob, 57 years of age, native of Switzerland, married, farmer, residence Hematite, MO", was admitted to the hospital Wednesday December 21, 1887 at 9:18 PM with the following remarks on his permit- Injury to face, etc. Recommended by Dr. Steinmetz.

B. V. Steinmetz, M. D."

Patient entered the hospital at 9:18 PM Wednesday December 21, 1887 in a semi-conscious condition. We were able, after a good deal of effort to get from him his name but could get no particulars of the accident. From the Dispensary we learned that he was picked up near the mouth of the tunnel at the Union Depot. Examination revealed emphysema of left side of body from clavicle to crest of ilium, there were fractures of the 1st, 2d and 3d ribs near sternal end; the clavicle was dislocated backwards at the sternal articulations; there was a contused and lacerated wound on forehead just over right eye. The wound extended along the median line (7 centimeters]?) and along the eyebrow from the median line to the external angle of the orbit. On the right frontal eminence there were two small lacerated wounds of the integument under the right eye there was a lacerated wound of integument 5 cent. long and one at the external angle of the left eye 3 cent long. There was considerable ecchymosis of face. Emphysema entened over all the body and up the neck. On admission pulse was 120 per minute and fairly good, but after about an hour, became very rapid and fluttering. Respirations were stertorous. Patient died from shock, due to injuries received at 4:30 PM Thursday, December 22, 1887.

H. C. Dalton, M. D.

**Inquest** medical Coroner's Office  
St. Louis at 10` O.C. A.M. December 24, 1887  
**On The Body Of**  
**Henry Grob**

**#1**

Edward Morrissey being duly sworn testifies I am the tunnel watchman. At about 8 O.C. P.M. Dec 22st I discovered the deceased leaning against the wall of the tunnel last side he was badly injured. The C & A Train had just passed going east. I took him out and had him sent to the City dispensary, he was very weak and all I could learn from him was his name and that he resided in Jefferson County, MO. I afterwards learned that he had a ticket for the St. Louis J. M. & Southern Rd. And that he got on the wrong train and only discovered it as the train was about to enter the mouth of the tunnel and he jumped off and was badly injured. his

Edward X Morrissey mark

Sworn and subscribed before me this 24th day of December 1887. Thos J. H. \_\_\_\_\_ (?)  
Deputy Cor

**#2**

Jacob Grob being duly sworn testifies - I reside at Hematite Jefferson Co, MO. The deceased is my father. He also resides at Hematite. He is married and resides at the above place with his wife and six children. He left home Wednesday morning with his daughter who was on her way to Indiana to see her cousin(s) in Aurora. My father and sister were going to stop in the City to purchase some goods and He was to see her off the same evening and return home himself either that evening or next morning. I heard of his death through the News Papers. He was 55 years of age, born in Switzerland, occupation Farmer. I will bury his remains.

Jacob. Grob.

Sworn and subscribed before me this 24th day of December 1887 This. J. \_\_\_\_\_ (?)  
Deputy Corner

**VERDICT:**

That the deceased Henry Grob came to his death at the City Hospital at 4:30 O.C. P. M. Dec. 22nd 1887, from shock result of injuries received at the mouth of the tunnel near Spruce St.

R[ail] R[oad] Accident

The 1870 Census shows;

GROB, Henry, 37, Male, Farmer, born Switzerland; Margaret, 31, female, wife, keeps house, born Ireland; Jacob, 13, male, at home, born Indiana; John, 11, male, at home; Thomas, 9, male, at home; Henry, 7, male, at home; Ellen, 2, female, at home. John, Thomas, Henry, Ellen all born Missouri.

Henry Grob Probate #1888;

Jacob Grob Administrator, heirs Margret Grob (*Widow*), Jacob, John H., Thomas, William, Ella, Sarah all residing at Hematite.

Inventory by Jacob Grob, C. T. Lee, Jerry Kavanaugh on January 25, 1888.

80 acres S<sup>1</sup>/<sub>2</sub>/SW<sup>1</sup>/<sub>4</sub>, 15.5 Acres of SW<sup>1</sup>/<sub>4</sub> Section 21 Township 40 Range 5;

120 acres S<sup>1</sup>/<sub>2</sub>/SE<sup>1</sup>/<sub>4</sub>, E<sup>1</sup>/<sub>2</sub>/NE<sup>1</sup>/<sub>4</sub> Section 28 Township 40 Range 4

Appraisement; 1 Spam of mules \$160, 1 Wagon \$10,...

Receipt for Notices; April 10<sup>th</sup>, 17<sup>th</sup>, 24<sup>th</sup> and May 1<sup>st</sup> 1890 newspapers to Robert McMullin.



*Henry Grob Gravesite*

Margaret Henry's wife passes three years later on 24<sup>th</sup> March 1893 from a heart attack at the age of 60. Her statistics are carved on the back of Henry's monument.

As can be seen in Coxwell Funeral Parlor of De Soto, she was buried in the family cemetery.

There is a depression in the immediate area where a son-in-law is rumored to be buried. However there is no way to verify this.

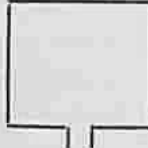

Number of Funeral _____ Number for the Current Year _____		Be careful to enter name of deceased and number of PAGE in index for future reference.	Items of Bill, (cross out printed items not furnished.)
Name of Dec'd <u>Mr. May's Grob</u> Late Residence <u>St. Charles Mo</u> Age <u>62</u> years _____ months _____ days Cause of Death <u>Heart</u> Certifying Physician <u>Dr. Eldon</u> Date of Death <u>March 4/28</u> Date of Burial _____ Funeral at House or _____ Church Place of Burial <u>Home</u> _____ Cemetery Grave or Lot No. _____ Section No. _____		Door Capn _____ Draperies _____ Candelabra and _____ Candles Washing & Laying out Remains, Shaving _____ Preservation of Remains _____ No. _____ Casket _____ Trimming _____ <u>5-6-28</u> <u>Home</u> <u>127.50</u> No. _____ Handles _____ No. _____ Plate engraved _____ Outside Box (Pine, Chestnut, Oak, Cedar), _____ Pine _____ H.O.P. _____ Common Box _____ Delivery to Cemetery _____ No. _____ Rule _____ <u>6.50</u> Pine _____ Gloves _____ Linen Scarfs _____ Use of _____ Dier. Chairs _____ Flowers _____ Hearse _____ Carriages to _____	
Location of Grave <input checked="" type="checkbox"/>  (Draw lines) for Grave in the Plot, and designate this one with a double cross. Show position of monument by 			
Inscription _____ on Plate _____ Measurement { Length to Heel _____ feet _____ in. } { Width at Shoulder _____ } Bill Rendered to _____ When Rendered _____		Advertising _____ Cemetery charges _____ Transportation Expenses, &c _____ Attendance & Assistants _____ Amount of Bill _____ Amount Brought Forward _____ <u>34.00</u> Amount Carried Forward _____	
MEMORANDUM. <u>Dr. John H. Grob</u> <u>Mr. Sam. H. H. H.</u>		PAYMENTS. <u>By Cash May 27/28</u> <u>Dr. John H. Grob</u> <u>34.00</u>	
ITEMS OF EXPENSE.			

Henry Grob Gravesite

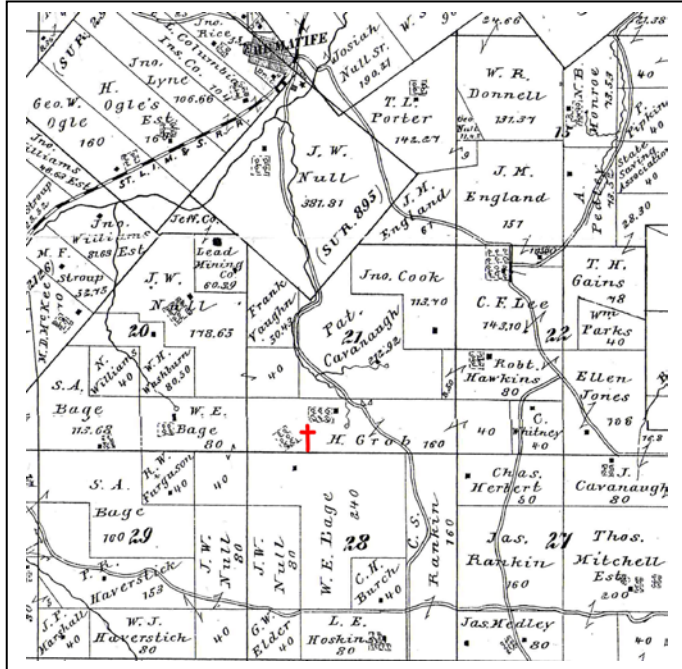

As can be seen in the 1876 Historic Atlas at left Henry Grob owns 200 acres in T40 R4 S21 & 22, with two orchards, and two mines, south of the town of Hematite.

The 1898 Standard Atlas shows the land where the graveyard is as being owned by Martin Belcher with Ella Grob owning the land to the east and Malcom Jacob Grob and brothers owning to the east of Ella's 48 acres.

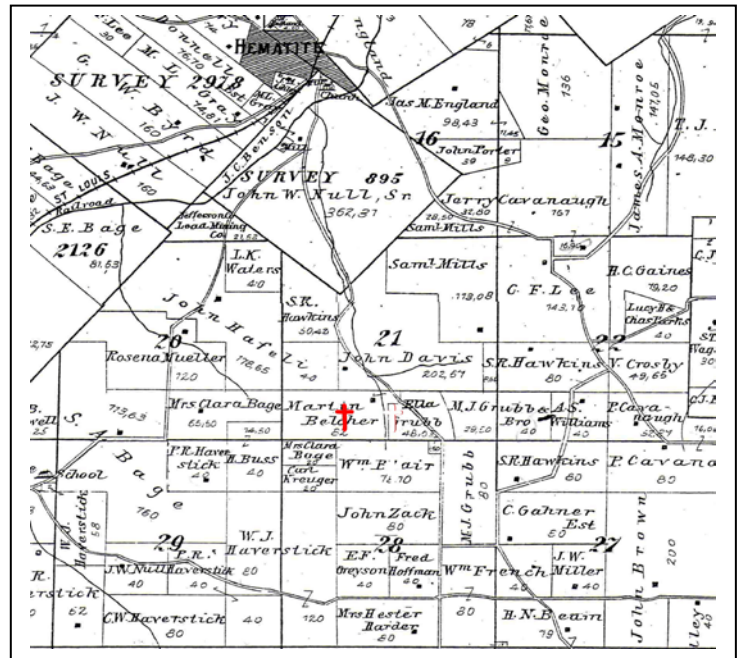

Copyright © 2014 by Dave Hallemann

This article may not be used for commercial purposes, may be distributed in any form for family genealogical and historical purposes as long as there is no fee charged, and the author is given credit.