

Edwards Cemetery

By Dave Hallemann

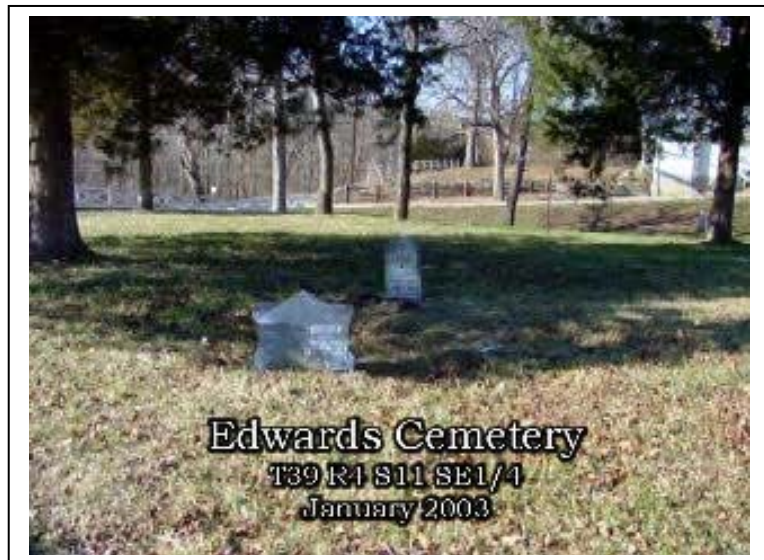

This beautiful well-kept cemetery is located in T39 R4 S11 NE¼ of the SE¼ just off Highway V.

38° 6' 34" N / 90° 32' 43" E

The cemetery is named for George W. Edwards who first entered this tract on 1st October 1840, and recorded as Certificate #8896, for the E½ of the SE¼ T39 R4 S11.

The 1840 census show George W. Edwards's household has 1 male between the ages of 20-30 with 2 female children less than 5 years old, and 1 female between 15-20.

In the 1850 census George is listed as being a 38 years old farmer, with Susan his wife being 29, and children; Dorothy A. 12, Emma 10, William J. 8, and Sarah E. 6 years old. Also listed are Henry Staples 45 with the notation (crazy) and Susan Kinney 38 years old.

On Thursday, 16 March 1854, Dorothy Edwards marries Samuel McMullin.

By the 1860 census George is 40 (typo 48?), Susan is now 39, William is still at home at age 18, Sarah now 16, is listed as well a new comer Newton (Oscar) age 2. Susan Kinney is now 75(?) and still living on the farm.

On 25th January 1860 at age 20, Emma Edwards married Noah Fauber who on the 1898 Atlas owns the tract adjoining on the north and is listed next after George in the 1860 census as Fawber a 26 year old carpenter with his wife Emma as being 20.

15 December 1864 Sarah E. Edwards marries John S. McMullin.

George W. Edwards died between 1860 when the census was taken and 1864. In Probate Record # 672, Susan Edwards refuses Administrator rights to the Estate of George W. Edwards, signing refusal document with her mark (X). Heirs are listed as D(orothy) McMullin, E(mma) Fauber, W^m. J. Edwards, Sarah Edwards, and N(ewton) O(scar) Edwards, with Samuel McMullin confirmed Administrator. Although *unverified* George is probably buried here. Susan Edwards now is in possession of this tract.

Records show that Susan Edwards marries W^m. Donnell on Thursday, 19th January 1865. In the 1870 census W^m. Donnell a 56 year old farmer, along with his wife Susan 49 and her son (Newton) Oscar age 12, live on the farm.

In Probate 959, W^m. A. Donnell, born 21st September 1814 dies on 30th March 1873. Susan Donnell relinquishes her right to administrate the estate and his son Thomas N. Donnell is appointed Administrator. Susan again signing with her mark (X). It appears the W^m. A. Donnell

was indeed buried in his family's cemetery in Hematite. Our records confirm this. A receipt from John S. Klinefelter & Co., 1420 Broadway, Marble Dealers, for 1 set of Marble Grave Stones with socket, to be shipped to Hematite. Also in the probate file, a receipt for \$74.⁸⁰ from John Synes, for paling in graveyard and to paint palings per agreement. Paling is a fence. Records confirm that W^m is buried with his wife Emma Donnell who died in 1863 two years before he married Susan Donnell.

Probate 994a reflects that in 1873 Susannah Kinney dies. Also a receipt for taxes paid in Texas County. Her heirs are listed as Clarissa Whitehead; George Edwards, deceased; Heirs of Emma Donnell; Newton Oscar Edwards who died in 1873. Also in the probate file was a receipt from Administrator W. R. Donnell to R. L. Rosenbaug & Son for gravestones. An obituary I came across reflects that "Mr. Newton O. Edwards, who was for many years a resident of this county, died in Texas County, Mo., on the first day of this month, aged 72 years. He was born in Bedford County, Pa., April 30 1817. He was generally known as one of the best men in the county. He was a brother of the late Clarissa Whitehead, and the 1st of the family." Susannah Kinney is shown as being buried also in the Donnell Cemetery near Hematite.

The 1907 Jefferson County Directory shows that Oscar Edwards is a farmer and stock raiser located 2 miles SE of De Soto.

Coxwell Funeral Parlor of De Soto has the following entries in their records;

DONNELL, Mrs. Susan, died 10th April 1894, cause of death Pneumonia, aged 73 yrs., buried on the Aus (Oscar) Edwards Farm;

EDWARDS, Elaner S., died 3rd September 1916, cause of death Cardiac Asthma, aged 59 yrs 5 mo 1 day, buried on farm; (*I cannot verify that they was buried on this Edward's Farm*);

FAUBER, Emma, died 12-15-1917, age 78 yrs 14 days, cause of death Chronic Bronchitis, buried Edwards Cemetery.

Although I found no deed "excepting out" this cemetery, I may have simply missed it, however from the above evidence I have presented, I feel this cemetery should have the "official" name of **EDWARDS CEMERTRY**.

CERTIFICATE } **THE UNITED STATES OF AMERICA.** *111*
No. *8896* } **To all to whom these Presents shall come, Greeting:**

WHEREAS *George W. Edwards of Jefferson County Missouri*

has deposited in the **GENERAL LAND OFFICE** of the United States, a Certificate of the **REGISTER OF THE LAND OFFICE** at *St. Louis* whereby it appears that full payment has been made by the said

George W. Edwards according to the provisions of the Act of Congress of the 24th of April, 1820, entitled "An Act making further provision for the sale of the Public Lands," for the East half of the South East quarter of Section eleven, in Township thirty nine, of Range four East in the District of Lands subject to sale at *St. Louis Missouri, containing eighty acres*

according to the official plat of the survey of the said Lands, returned to the General Land Office by the **SURVEYOR GENERAL**, which said tract has been purchased by the said *George W. Edwards*

NOW KNOW YE, That the **United States of America**, in consideration of the Premises, and in conformity with the several acts of Congress, in such case made and provided, **HAVE GIVEN AND GRANTED**, and by these presents **DO GIVE AND GRANT**, unto the said *George W. Edwards*

and to *his* heirs, the said tract above described: **TO HAVE AND TO HOLD** the same, together with all the rights, privileges, immunities, and appurtenances of whatsoever nature, thereunto belonging, unto the said *George W. Edwards*

and to *his* heirs and assigns forever.

In Testimony Whereof, *Martin Van Buren* **PRESIDENT OF THE UNITED STATES OF AMERICA**, have caused these Letters to be made **PATENT**, and the **SEAL** of the **GENERAL LAND OFFICE** to be hereunto affixed.

GIVEN under my hand at the **CITY OF WASHINGTON**, the *first* day of *October* in the Year of our Lord one thousand eight hundred and *forty* and of the **INDEPENDENCE OF THE UNITED STATES** the Sixty *fifth*



BY THE PRESIDENT: *Martin Van Buren*
By *M. Van Buren* Sec'y.

James Edward Leasing **RECORDER** of the General Land Office.
(ad interim)

Above is a copy of the original Certificate issued by the United States Government to George W. Edwards dated 1st October 1840, recorded as Certificate #/8896, and signed by President Martin Van Buren. These Certificates were issued to the first person that purchased the land from the U. S. Government. Subsequent deed transfers are recorded as Warranty Deeds in the Recorder Of Deeds Office. This Certificate is for the E½ of the SE¼ of Township 39 Range 4 Section 11, containing 80 acres.

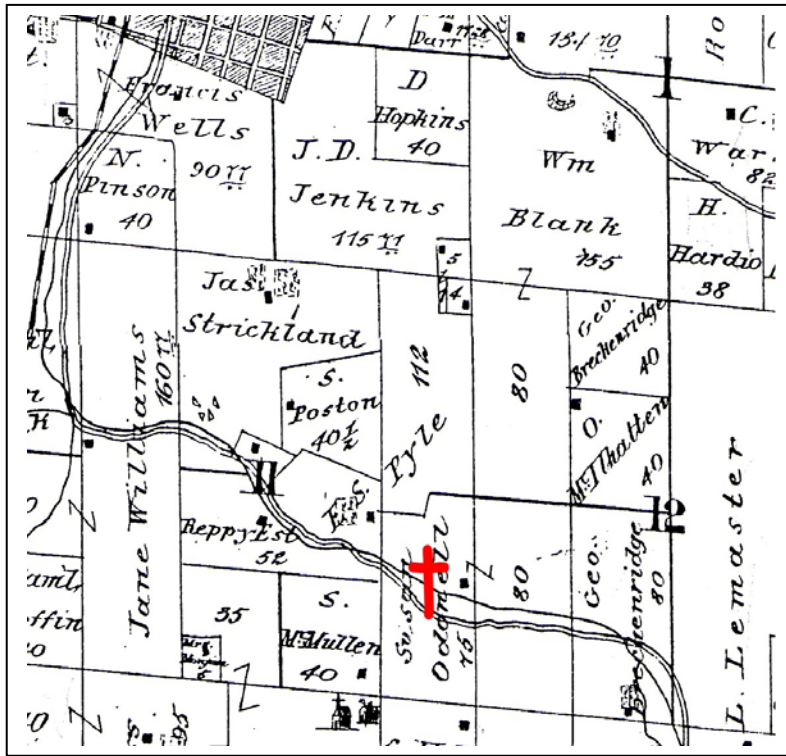

The 1876 Historic Atlas shows the farm in the possession of Susan O donnell (Donnell).

The cross I added to the photo.

The 1898 Standard Atlas shows Oscar Edwards owns the tract where the cemetery resides. Note the Noah Fauber tract adjoining to the north. On 26th January 1860 Emma Edwards married Noah Fauber. As before I added the cross to show location.

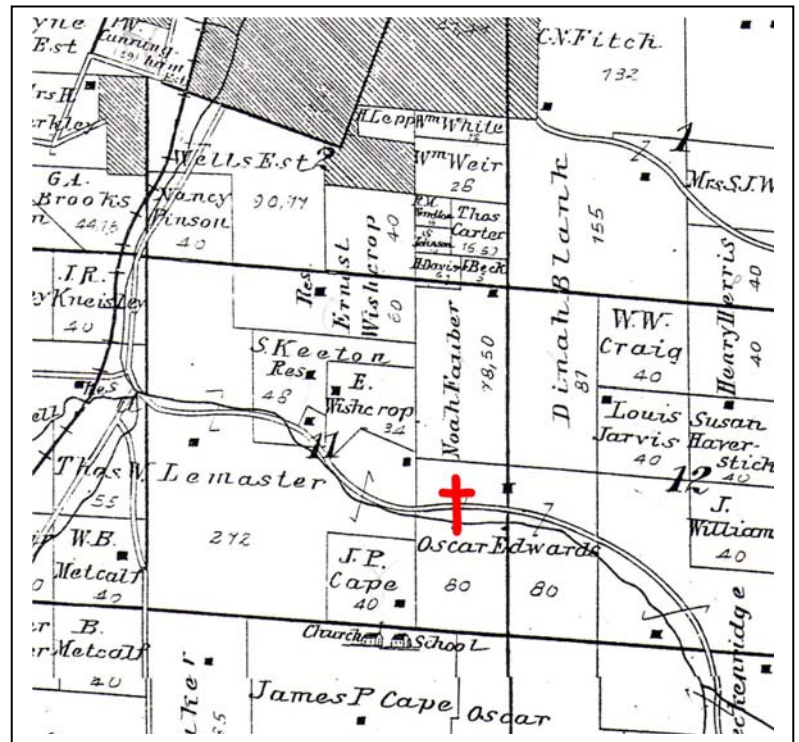

The following persons are listed on the monuments in this cemetery;

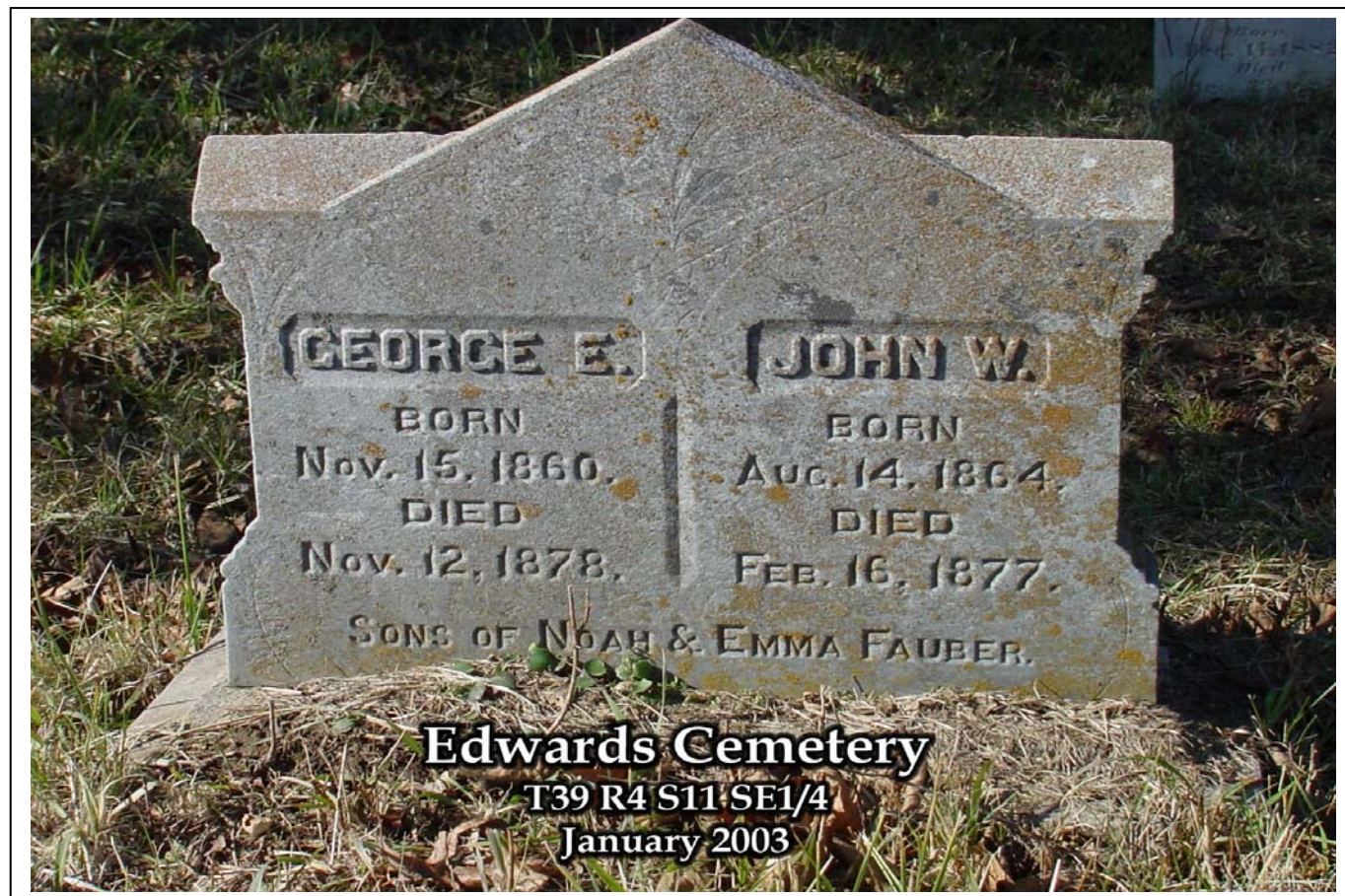

George E.

Born
November 15, 1860

Died
November 12, 1878

John W.

Born
August 14, 1864

Died
February 16, 1877

Sons of Noah and Emma (*Edwards*) Fauber

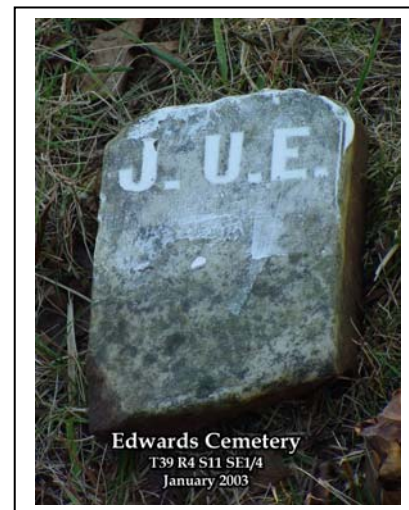
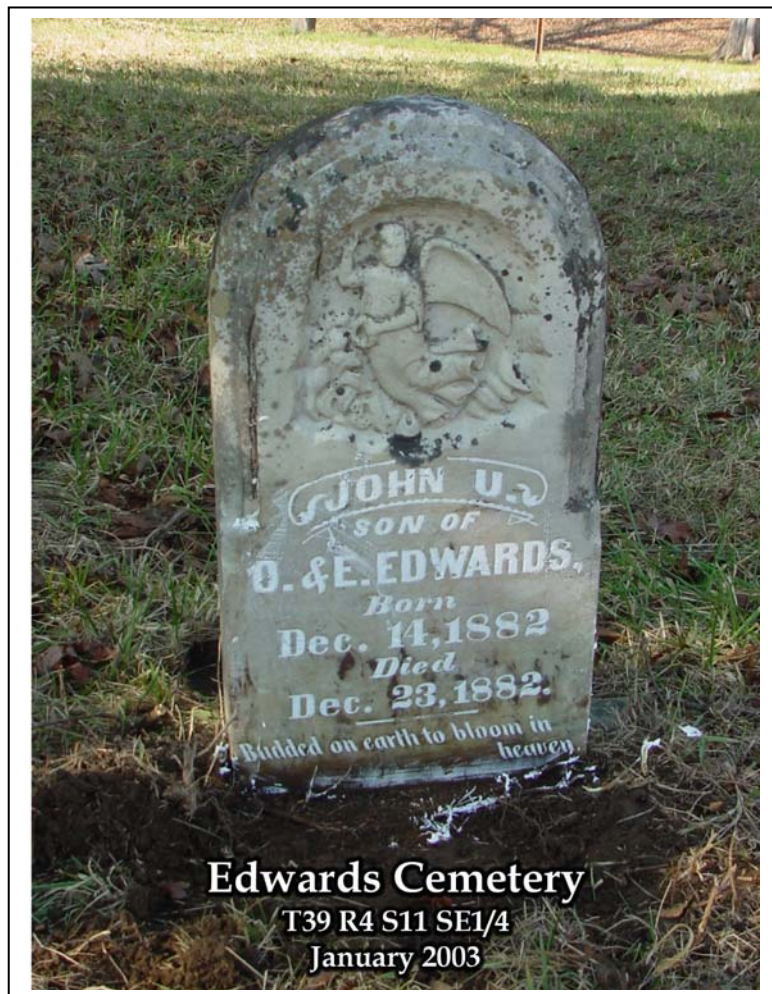

(footstone)

John U.

Son Of
O. & E. Edwards
Born
December 14, 1882
Died
December 23, 1882

Budded on earth to bloom in Heaven.

*Copyright © 2003 by Dave Halleman
This article may be distributed in any form as long as there
is no fee charged, it is transferred in its entirety, and the author is given credit.*